

GeN2™

OTIS

Catalogue Layout
630 - 1000 kg

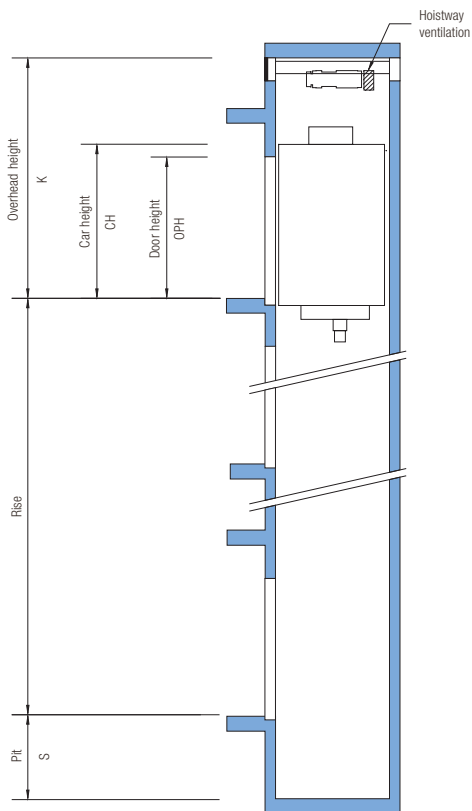

Machine mounting

Plan view

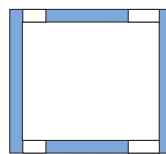

Machine on the right

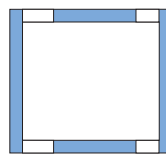

Machine on the left

Lifts in bank

Lifts in bank are available up to 5-car group; please consult Otis for detailed information.

Door mounting

In hoistway

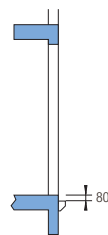

On landing

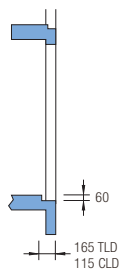

S (mm)

Counterweight without safety gear	8 pers. Deep car	13 pers. Deep car	10 pers. Wide car 1 entr.	10 pers. Wide car 2 entr.	13 pers. Wide car 1 entr.	13 pers. Wide car 2 entr.
Speed (m/s)	1.00*		1120			
	1.60		1400			
	1.75		1500			

K (mm)

Speed (m/s)	K min. (mm)
1.00	CH + 1180
1.60	CH + 1400
1.75	CH + 1500

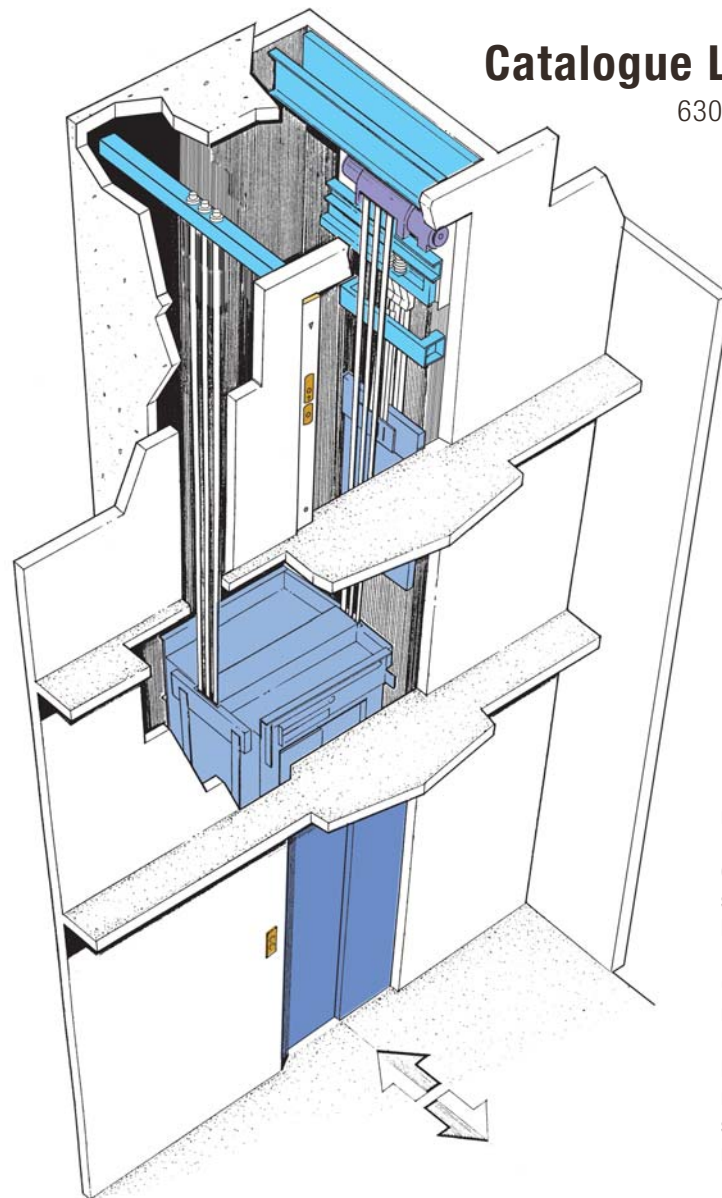

Machine roomless

Coated steel belts

Gearless machine

Permanent magnet synchronous motor

* If rise > 40 m, consult Otis.

Side opening (TLD) Right hand (opposite hand is available)

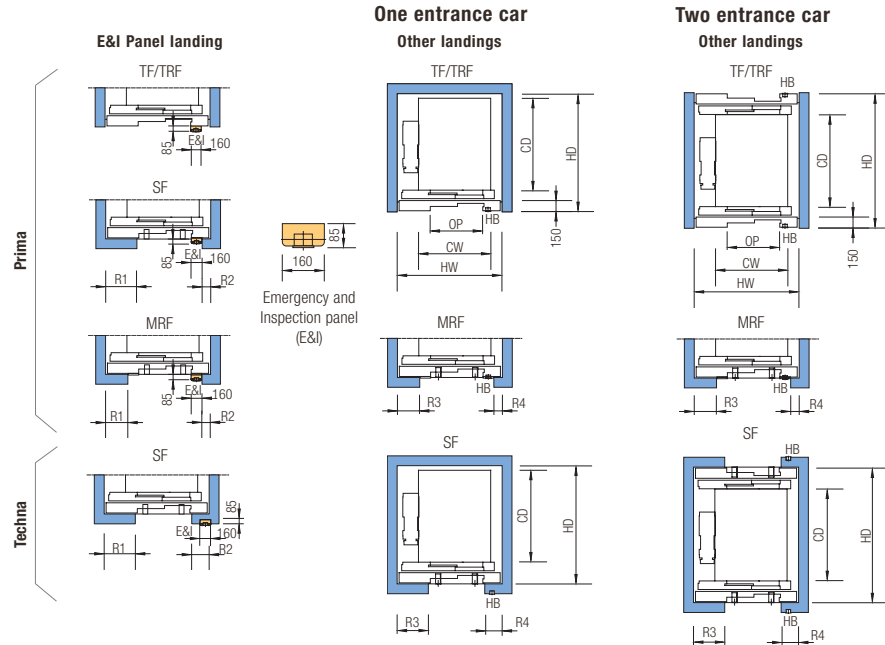

Centre opening (CLD) One entrance car

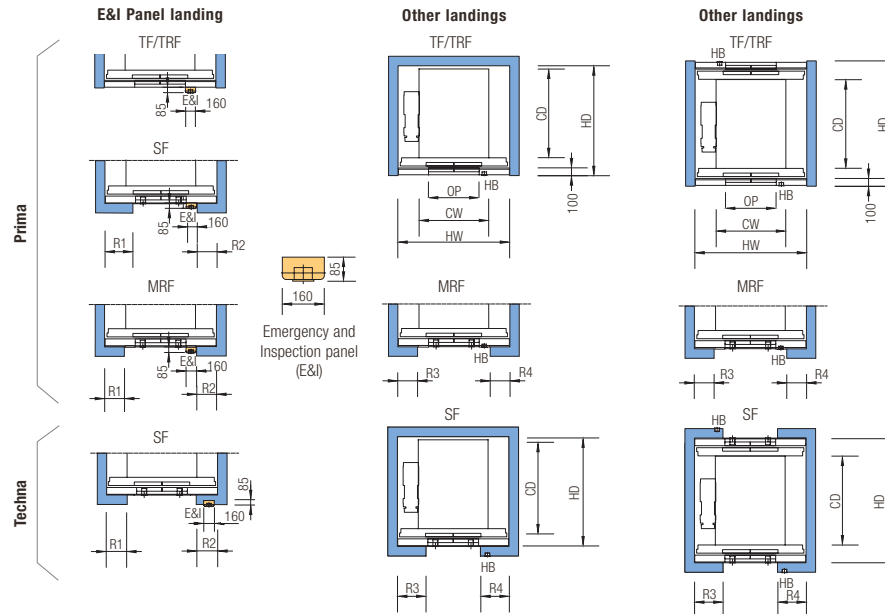

Hoistway dimensions - Counterweight without safety gear

Lift capacity	Load and passenger number	Rated speed V (m/s)	Internal car sizes		Door		Hoistway dimensions			
			Width CW (mm)	Depth CD (mm)	Type	Opening OP (mm)	Width HW (mm)	Depth HD (mm)	Depth HD (mm)	
							1 entrance	2 entrances		
630 kg 8 pers. Deep car	1.00 1.60 1.75	1100	1400	TLD	800	1600	1820	2100		
					900	1670	1820	2100		
					CLD	800	1800	1800	2000	
						900	2000	1800	2000	
800 kg 10 pers. Wide car	1.00 1.60 1.75	1350	1400	TLD	900	1900	1850	2100		
					800	1900	1800	2000		
				CLD	900	2000	1800	2000		
					800	1600	2520	2800		
1000 kg 13 pers. Deep car	1.00 1.60 1.75	1100	2100	TLD	900	1670	2520	2800		
					800	1800	2470	2700		
				CLD	900	2000	2470	2700		
					900	2150	1800	2000		
1000 kg 13 pers. Wide car	1.00 1.60 1.75	1600	1400	CLD	900	2150	1800	2000		
					1100	2400	1800	2000		

Number of passengers	Door type	Door opening (mm)	Machine location*	Return walls											
				E&I landing						Other landings					
				R1 (mm)		R2 (mm)		R3 (mm)		R4 (mm)		SF		MRF	
				Prima	Techna	Prima	Techna	Prima	Techna	Prima	Techna	Prima	Techna	Prima	Techna
8 pers. and 13 pers.	TLD	800	Left	605	605	455	115	245	95	605	455	245	95		
			Right	115	245	95	605	605	455	245	95	605	455		
		900	Left	575	575	425	45	175	25	575	425	175	25		
			Right	45	175	25	575	575	425	175	25	575	425		
		800	Left	580	580	430	320	450	300	580	430	450	300		
			Right	320	450	300	580	580	430	450	300	580	430		
	900	Left	520	520	370	370	500	350	520	370	500	350			
		Right	370	500	350	520	520	370	500	350	520	350			

Number of passengers	Door type	Door opening (mm)	Machine location*	Return walls											
				E&I landing						Other landings					
				R1 (mm)		R2 (mm)		R3 (mm)		R4 (mm)		SF		MRF	
				Prima	Techna	Prima	Techna	Prima	Techna	Prima	Techna	Prima	Techna	Prima	Techna
10 pers. and 13 pers.	TLD	900	Left	725	725	575	45	175	25	725	575	175	25		
			Right	45	175	25	725	725	575	175	25	725	575		
		800	Left	545	545	395	325	455	305	545	395	345	305		
			Right	325	455	305	545	545	395	455	305	545	395		
		900	Left	505	505	355	365	495	345	505	355	495	345		
			Right	365	495	345	505	505	355	495	345	505	355		
	900	Left	655	655	505	365	495	345	655	505	495	345			
		Right	365	495	345	655	655	505	495	345	655	505			
	1100	Left	-	600	-	-	600	-	-	600	-	-	600	-	
		Right	-	600	-	-	600	-	-	600	-	-	600	-	

Key	Definition	Key	Definition	Key	Definition
CD	Car internal depth	HW	Hoistway width	WTW	Wall to wall
CH	Car internal height	K	Overhead height	TF/TRF	Total Frame / Total Reduced Frame
CLD	Central landing door	OP	Car opening width	SF	Small Frame
CW	Car internal width	OPH	Car opening height	MRF	Medium Frame
HD	Hoistway depth (including hoistway door)	S	Pit depth		
		TLD	Telescopic landing door		

Hoistway dimensions - Counterweight with safety gear

Lift capacity	Load and passenger number	Rated speed V (m/s)	Internal car sizes		Door		Hoistway dimensions				
			Width CW (mm)	Depth CD (mm)	Type	Opening OP (mm)	Width HW (mm)	Depth HD (mm)	Depth HD (mm)	Depth HD (mm)	
							1 entrance	2 entrances	1 entrance	2 entrances	
630 kg 8 pers. Deep car	1.00 1.60 1.75	1100	1400	TLD	800	1750	1750	1820	2100		
					900	1750	1750	1820	2100		
					CLD	800	1930	1930	1800	2000	
						900	2020	2020	1800	2000	
800 kg 10 pers. Wide car	1.00 1.60 1.75	1350	1400	TLD	900	1900	2020	1850	2100		
					800	1900	2020	1800	2000		
				CLD	900	2000	2120	1800	2000		
					800	1750	1750	2520	2800		
1000 kg 13 pers. Deep car	1.00 1.60 1.75	1100	2100	TLD	900	1750	1750	2520	2800		
					900	1750	1750	2520	2800		
				CLD	800	1930	1930	2470	2700		
					900	2020	2020	2470	2700		
1000 kg 13 pers. Wide car	1.00 1.60 1.75	1600	1400	CLD	900	2150	2270	1800	2000		
					1100	2400	2500	1800	2000		

Number of passengers	Door type	Door opening (mm)	Machine location*	Return walls											
				E&I landing						Other landings					
				R1 (mm)		R2 (mm)		R3 (mm)		R4 (mm)		SF		MRF	
				Prima	Techna	Prima	Techna	Prima	Techna	Prima	Techna	Prima	Techna	Prima	Techna
8 pers. and 13 pers.	TLD	800	Left	605	605	455	115	245	95	605	455	245	95		
			Right	115	245	95	605	605	455	245	95	605	455		
		900	Left	575	575	425	45	175	25	575	425	175	25		
			Right	45	175	25	575	575	425	175	25	575	425		
		800	Left	580	580	430	320	450	300	580	430	450	300		
			Right	320	450	300	580	580	430	450	300	580	430		
	900	Left	520	520	370	370	500	350	520	370	500	350			
		Right	370	500	350	520	520	370	500	350	520	350			

Number of passengers	Door type	Door opening (mm)	Machine location*	Return walls											
				E&I landing						Other landings					
				R1 (mm)		R2 (mm)		R3 (mm)		R4 (mm)		SF		MRF	
				Prima	Techna	Prima	Techna	Prima	Techna	Prima	Techna	Prima	Techna	Prima	Techna
10 pers. and 13 pers.	TLD	900	Left	725	725	575	45	175	25	725	575	175	25		
			Right	45	175	25	725	725	575	175	25	725	575		
		800	Left	545	545	395	325	455	305	545	395	345	305		
			Right	325	455	305	545	545	395	455	305	545	395		
		900	Left	505	505	355	365	495	345	505	355	495	345		
			Right	365	495	345	505	505	355	495	345	505	355		
	900	Left	845	845	695	45	175	25	845	695	175	25			
		Right	45	175	25	845	845	695	175	25	845	695			
	800	Left	665	665	515	325	455	305	665	515	455	305			
		Right	325	455	305	665	665	515	455	305	665	515			
	900	Left	625	625	475	365	495	345	625	475	495	345			
		Right	365	495	345	625	625	475	495	345	625	475			
13 pers. and 1 entr.	TLD	900	Left	655	655	505	365	495	345	655	505	495	345		
			Right	365	495	345	655	655	505	495	345	655	505		
1100	CLD	900	Left	-	600	-	-	600	-	-	600	-	-	600	-
			Right	-	600	-	-	600	-	-	600	-	-	600	-

* With TLD, the machine is located on the side to which the door is opening.