

Gen2™

OTIS

Gen2™ System – Machineroomless (MRL)

21st century technologies and materials with 21st century objectives

- Energy efficiency
- Environmental responsibility
- Passenger Safety
- Increased usable space
- Streamlined architectural profile
- Timesaving installation

Experience a quiet, smooth ride and benefit from engineering innovation and design

Suitable for Residential and Commercial applications

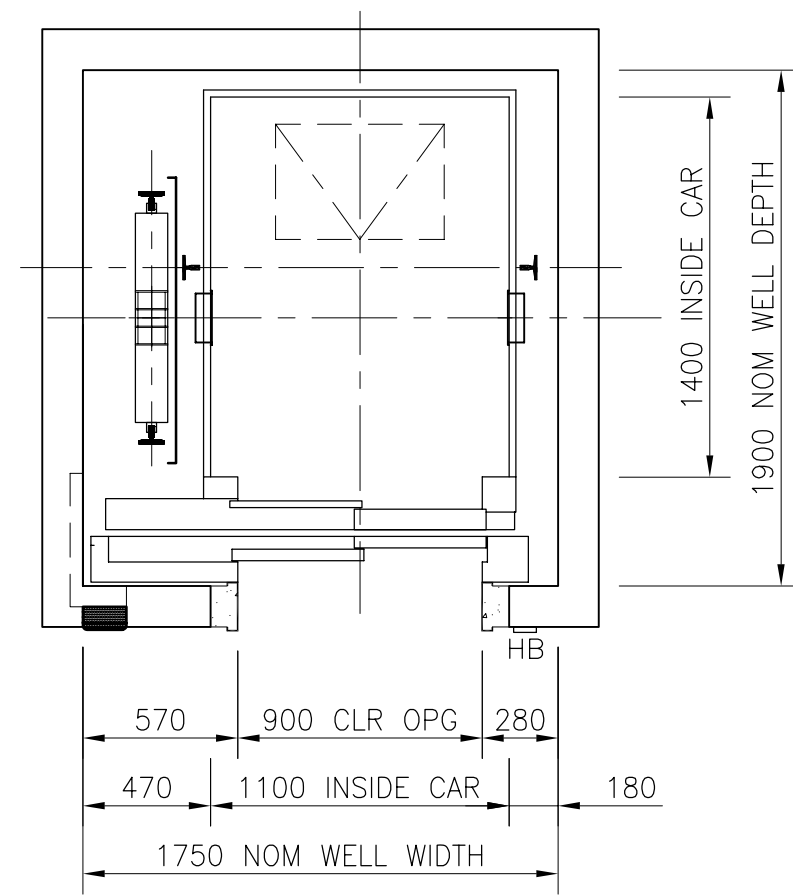

8 PERSON 630kg DEEP CAR

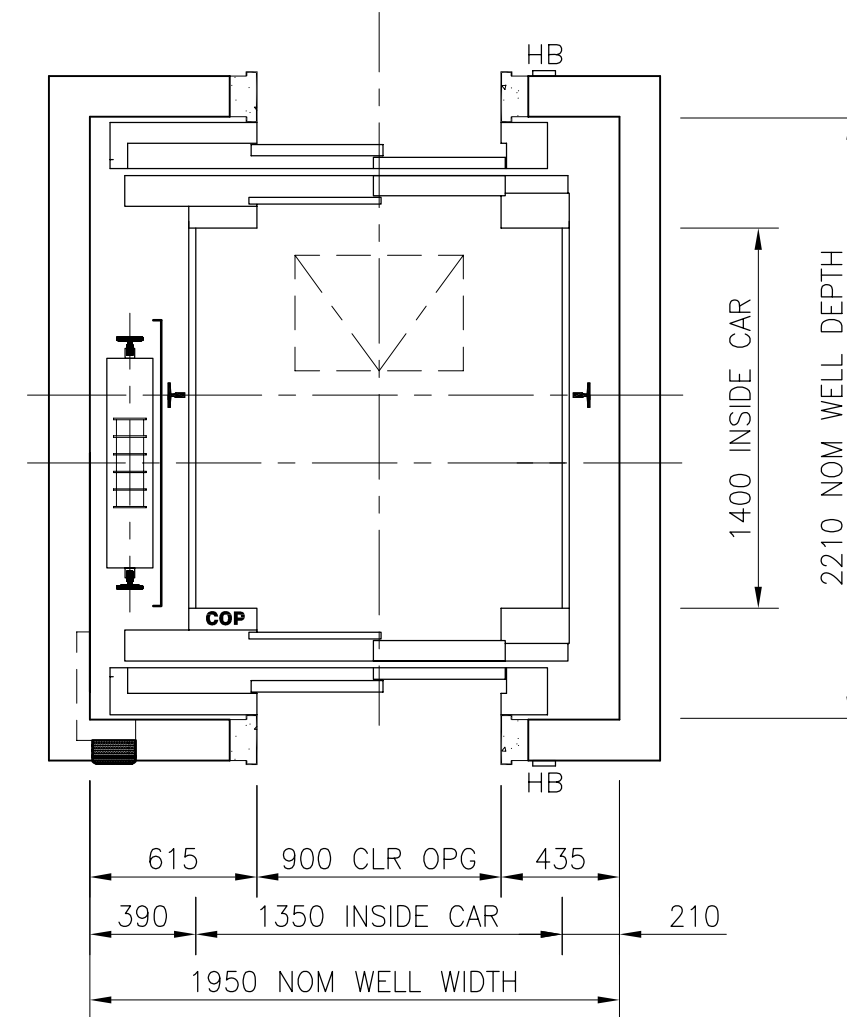
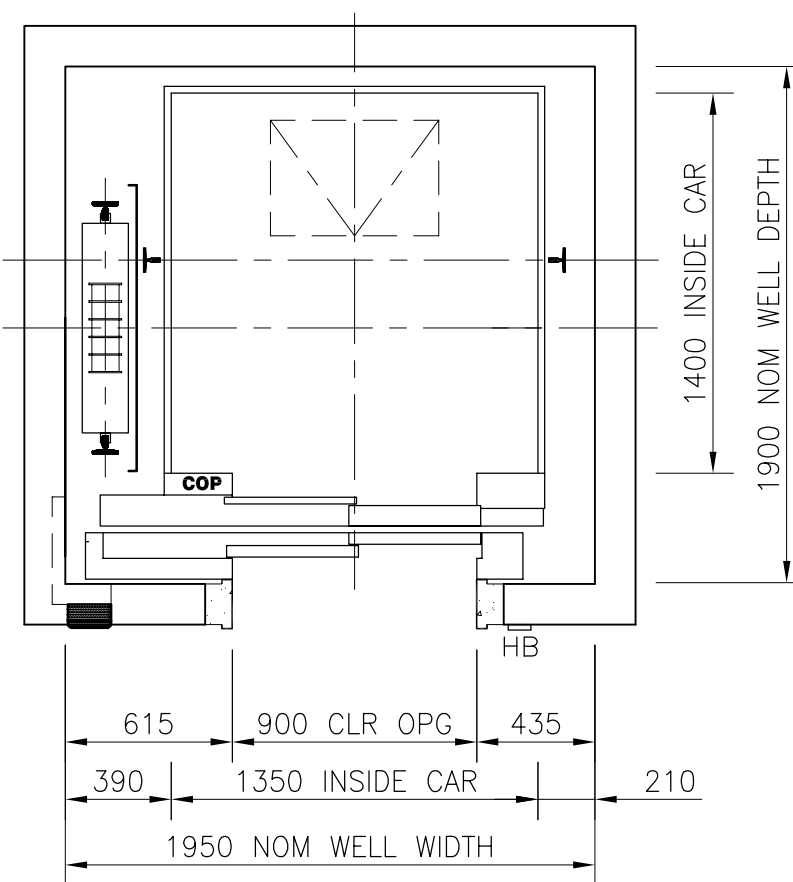

10 PERSON 800kg WIDE CAR

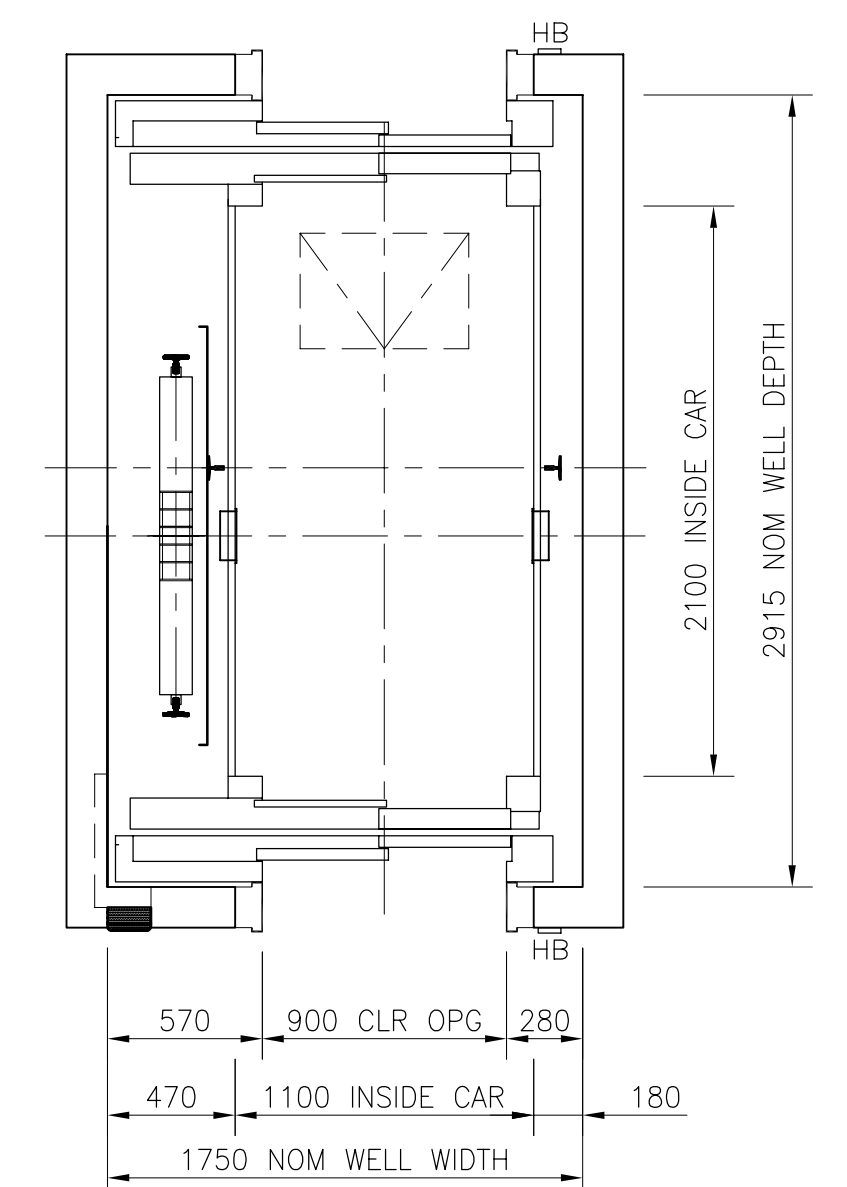
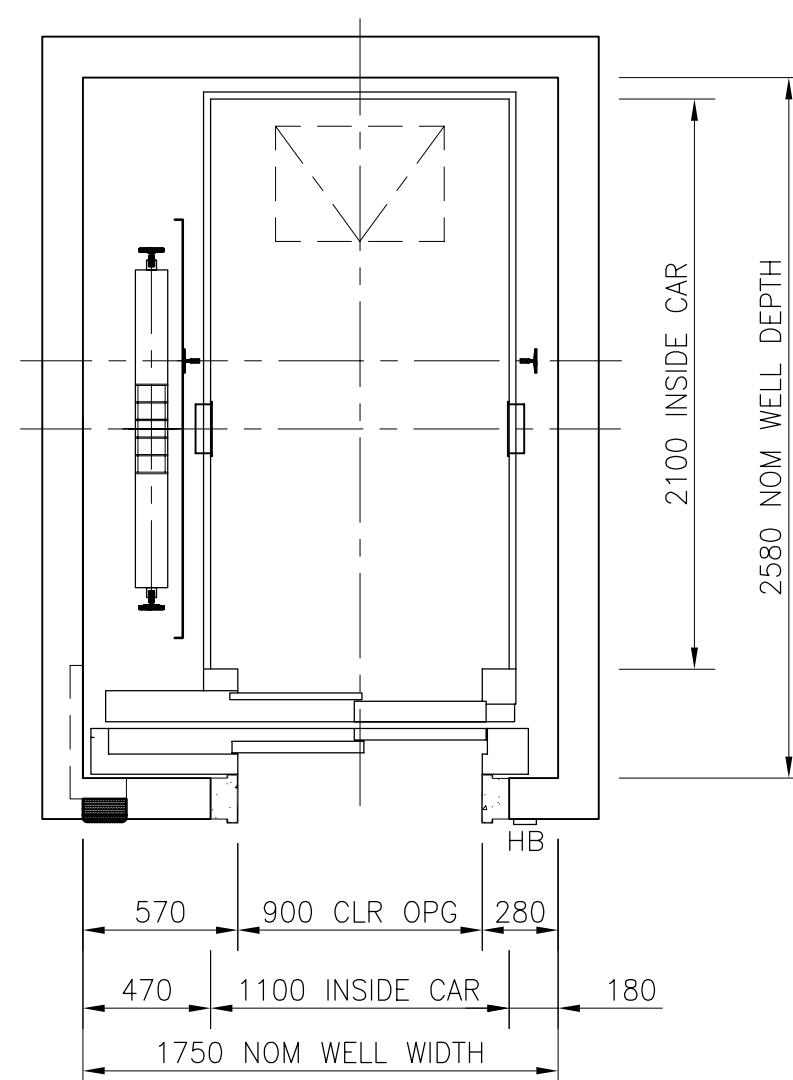

13 PERSON 1000kg DEEP CAR

Features

- Compact, energy efficient gearless machine
- Durable, quiet controller and drive
- Permanent magnet motor
- Highly sophisticated Remote Elevator Monitoring (REM®) controls
- Precision engineered governor
- Revolutionary coated steel belts
- Variable speed door control
- Easy access Emergency & Inspection controls

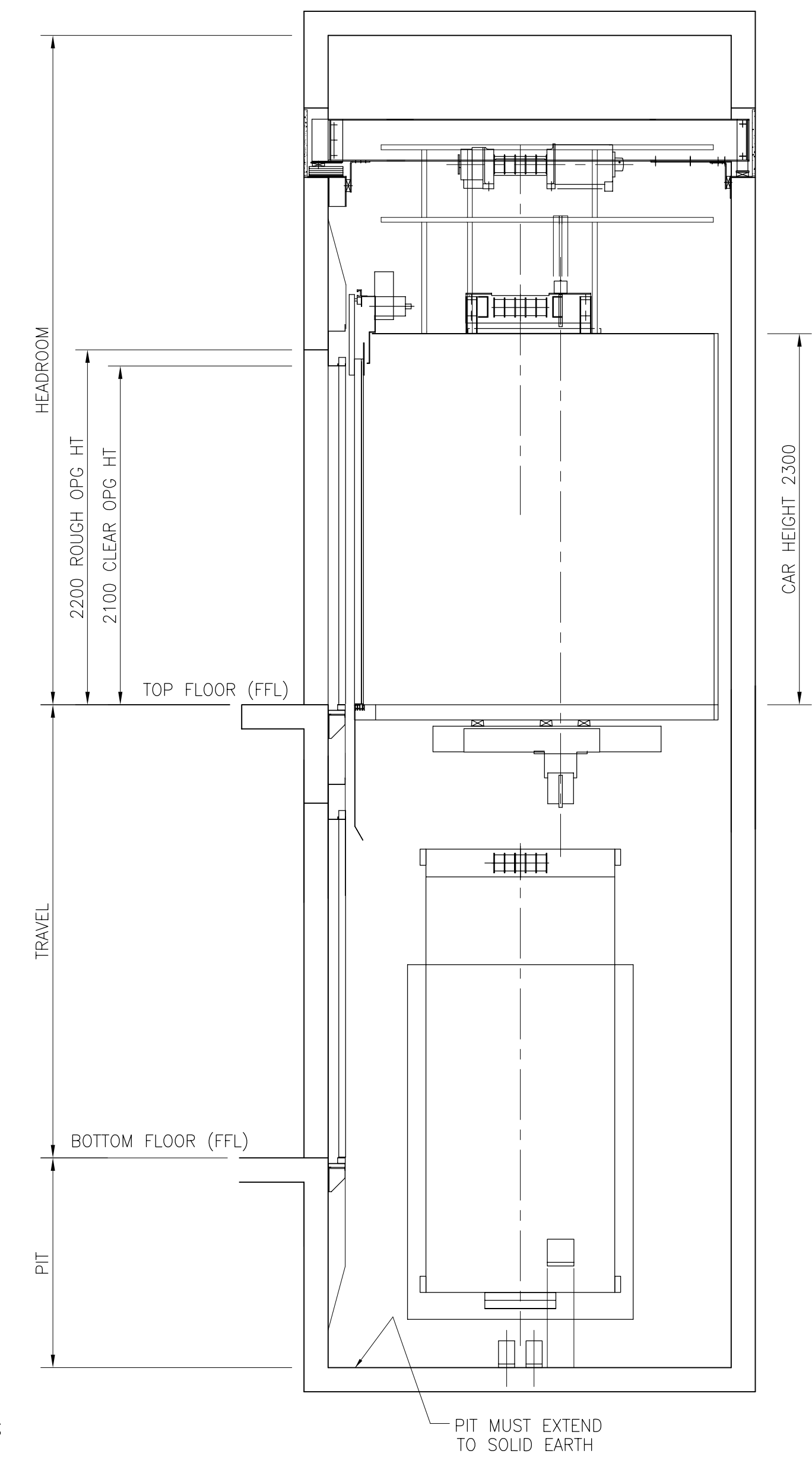

SPEED m.p.s.	1.0	1.6
HEADROOM mm	3700	3800
MAX TRAVEL mm	40000	75000
MAX No STOPS	14	21
PIT mm	1300	1400

All through-car configurations are limited to a maximum of 14 stops

Catalogue Layout

This design tool illustrates hoistway dimensions for the **Gen2™** elevator system

This is design information only – not to be used for construction purposes

Please contact Otis for full **Gen2™** layout information

Otis Elevator Company Pty Ltd has offices throughout Australia and New Zealand

www.otis.com

Note:

These dimensions assume a concrete hoistway structure
 All Two Speed Side Opening doors
 Opposite machinery location available
 Two and Three car arrangements available

FOR ITEMS TO BE PROVIDED BY PURCHASER REFER TO SHEET 2

Gen2™ Premier

MACHINEROOMLESS
 WITHOUT COUNTERWEIGHT SAFETY

DRG.No.L-4-DESIGN INFORMATION

DATE: MAY'2005 Dwg: SAA28158#### ALL RIGHTS RESERVED

OTIS

SHEET 1 OF 2