

8 PERSON 630kg DEEP CAR

Gen2™

OTIS

Gen2™ System – Machineroomless (MRL)

21st century technologies and materials with 21st century objectives

- Energy efficiency
- Environmental responsibility
- Passenger Safety
- Increased usable space
- Streamlined architectural profile
- Timesaving installation

Experience a quiet, smooth ride and benefit from engineering innovation and design

Suitable for Residential and Commercial applications

Features

- Compact, energy efficient gearless machine
- Durable, quiet controller and drive
- Permanent magnet motor
- Highly sophisticated Remote Elevator Monitoring (REM®) controls
- Precision engineered governor
- Revolutionary coated steel belts
- Variable speed door control
- Easy access Emergency & Inspection controls

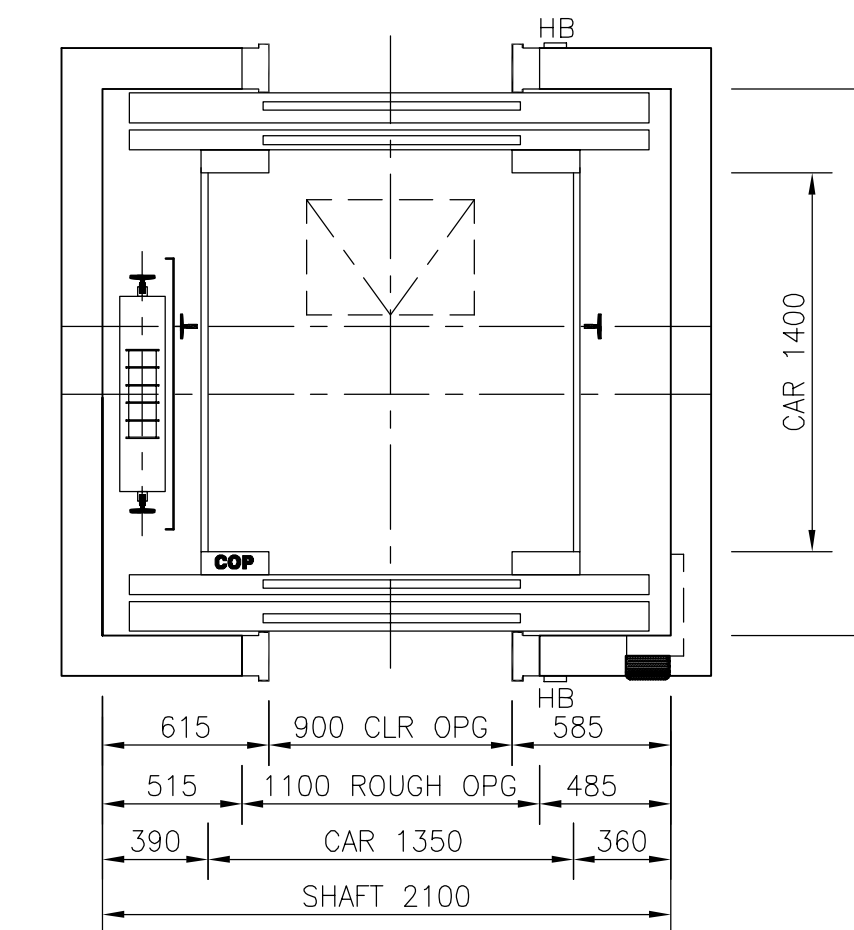
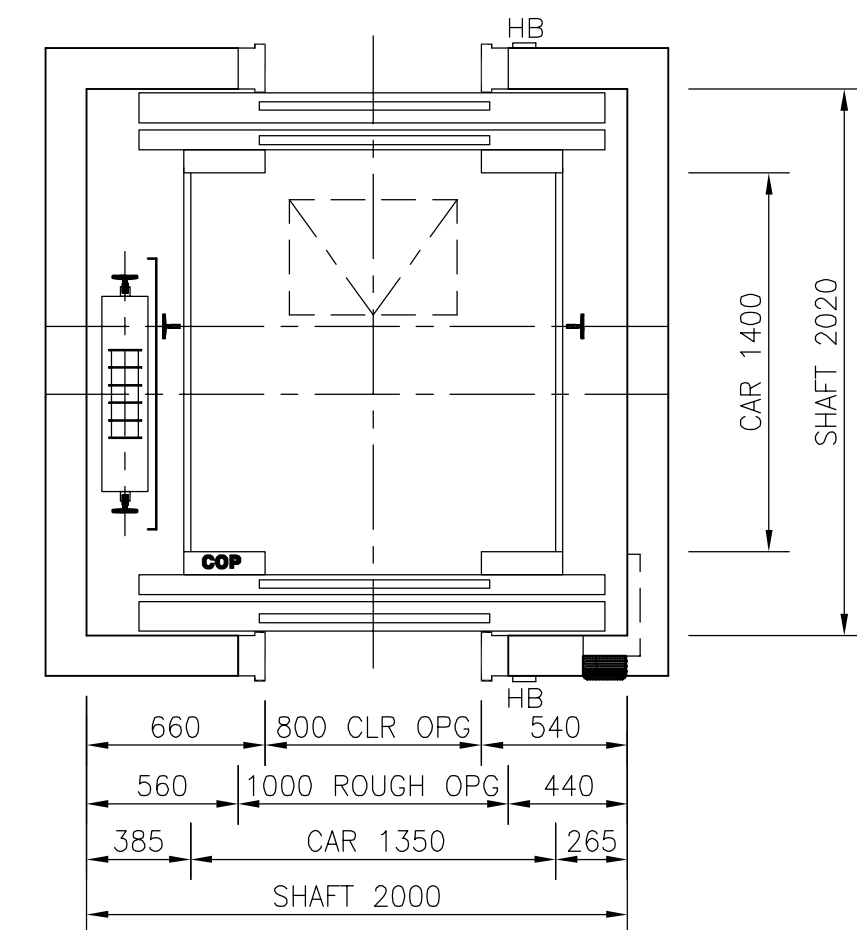
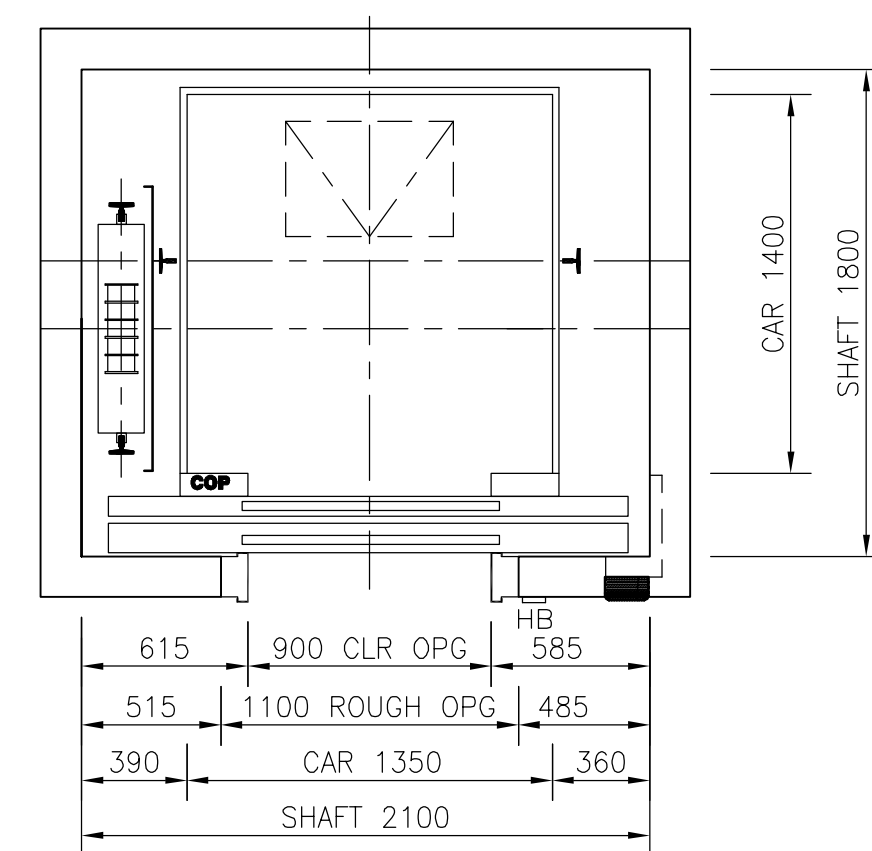
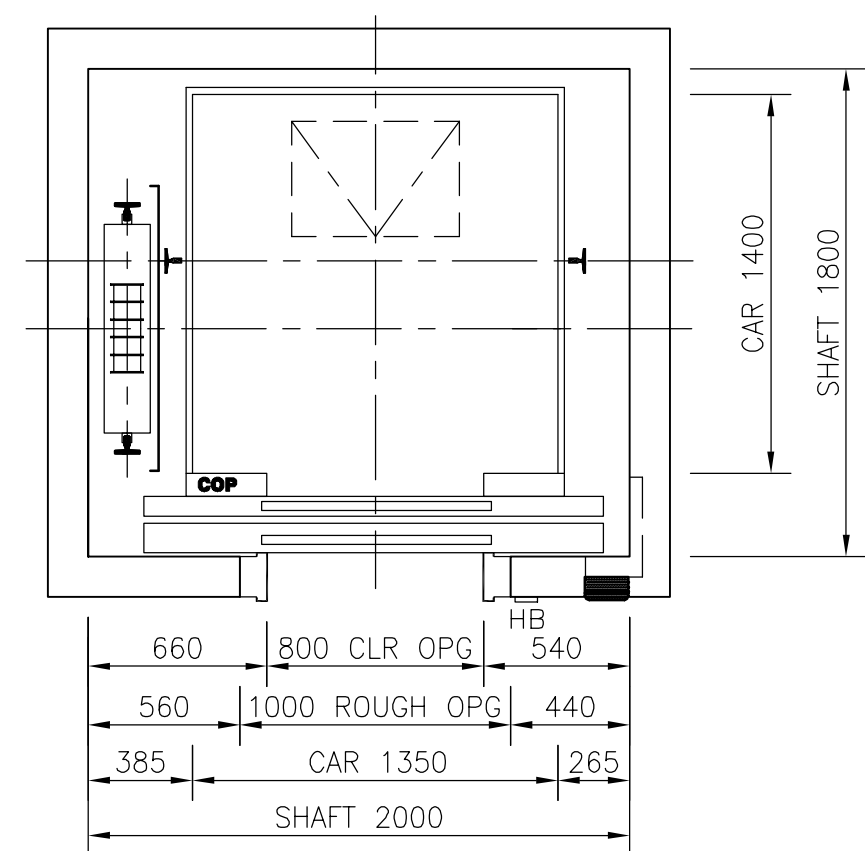
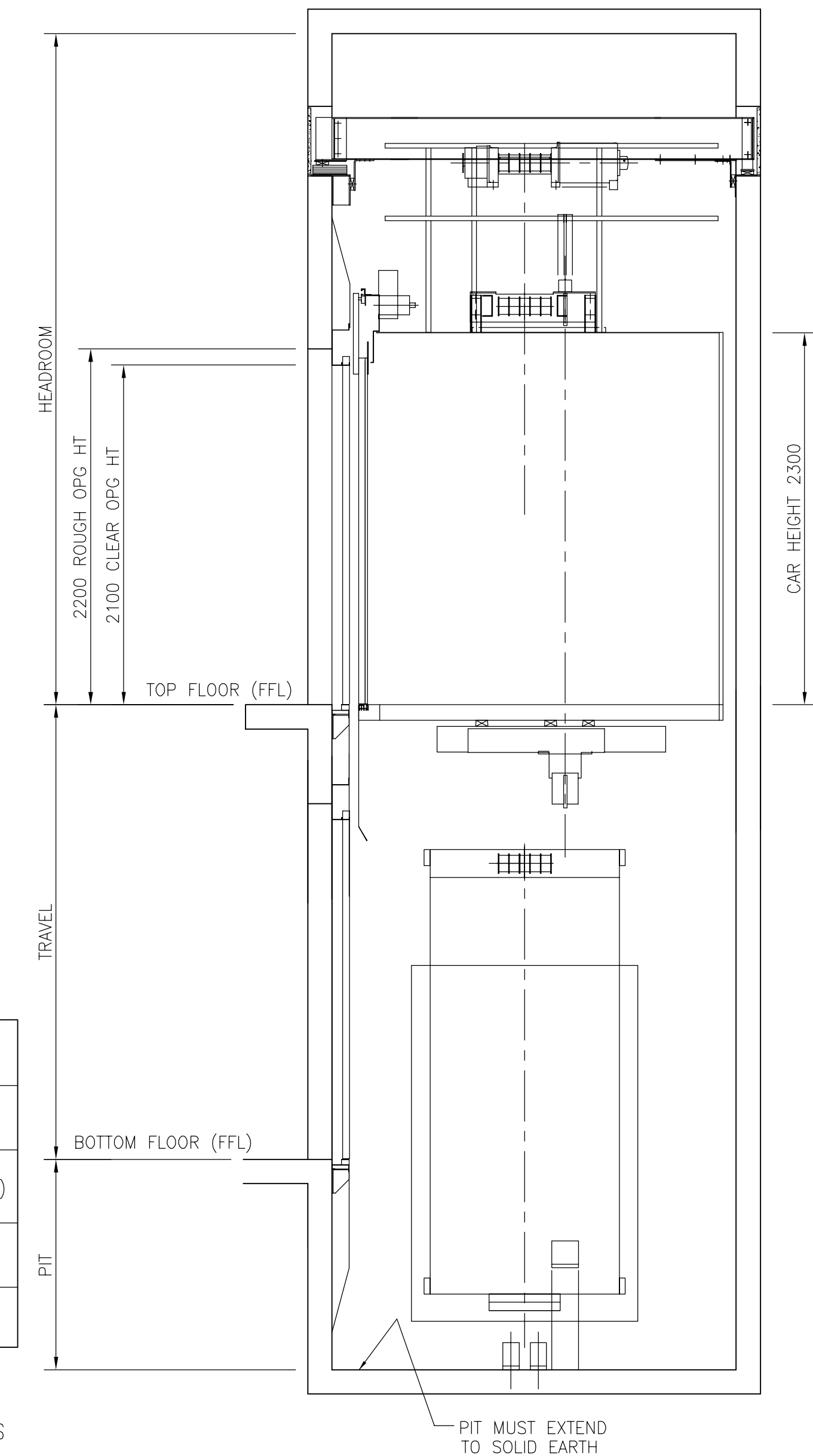

10 PERSON 800kg WIDE CAR

SPEED m.p.s.	1.0	1.6
HEADROOM mm	3700	3800
MAX TRAVEL mm	40000	75000
MAX No STOPS	14	21
PIT mm	1300	1400

All through-car configurations are limited to a maximum of 14 stops

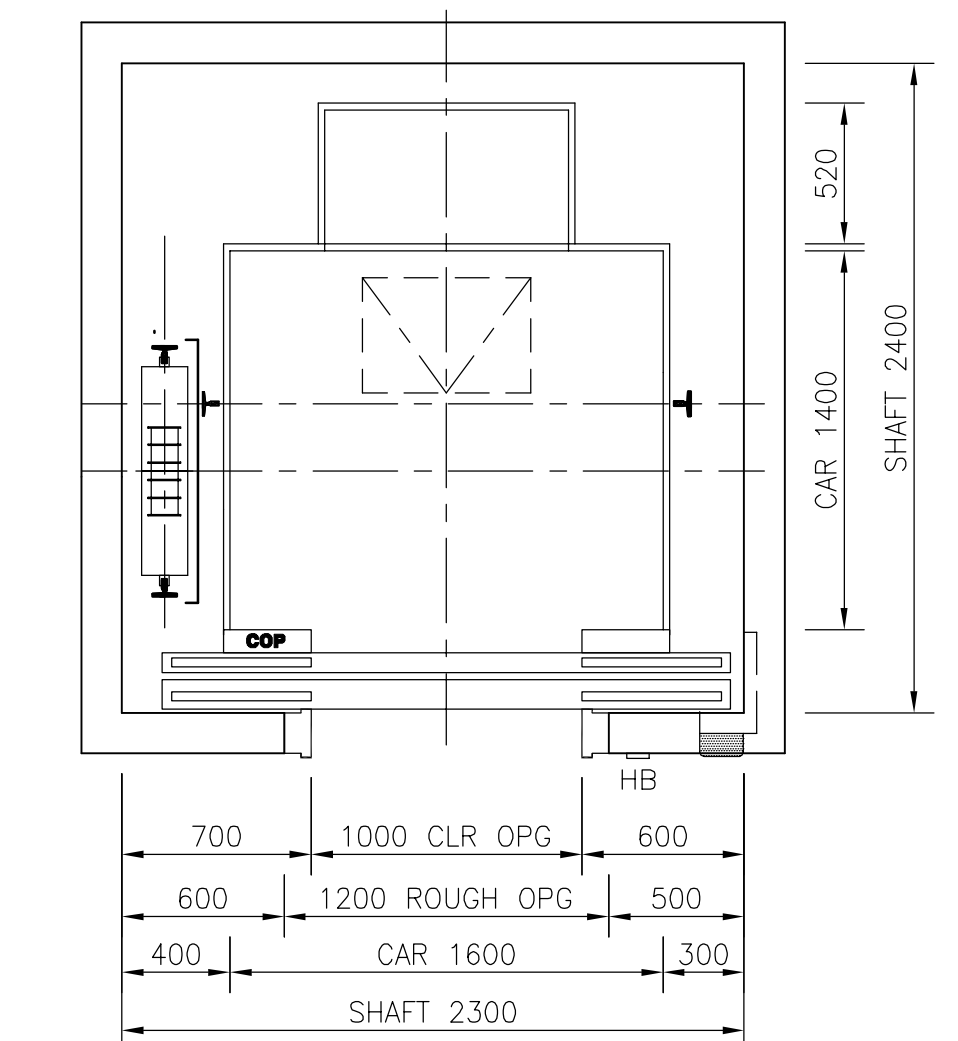
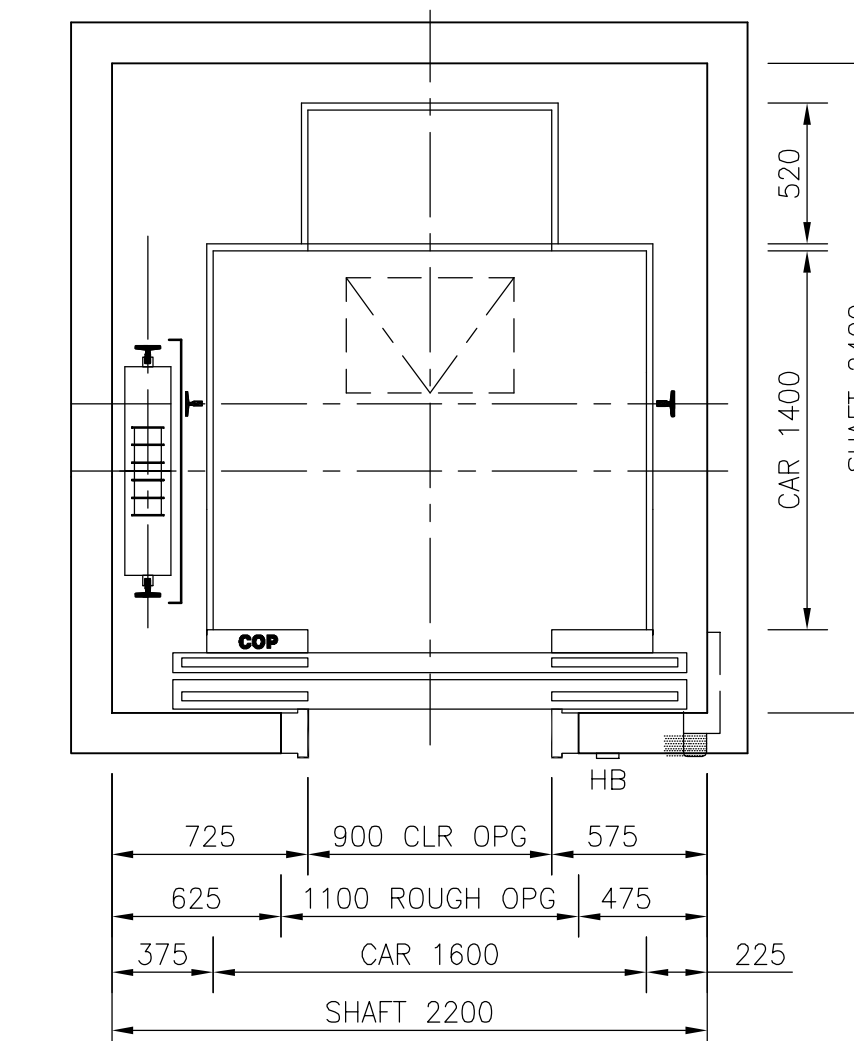
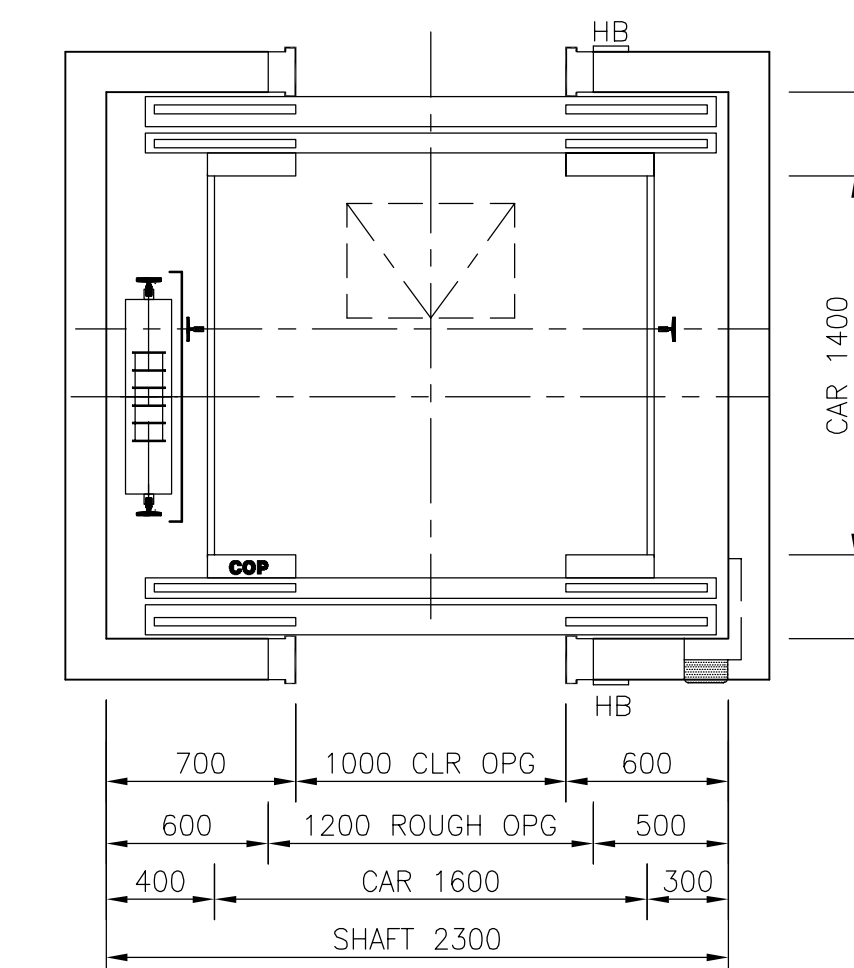
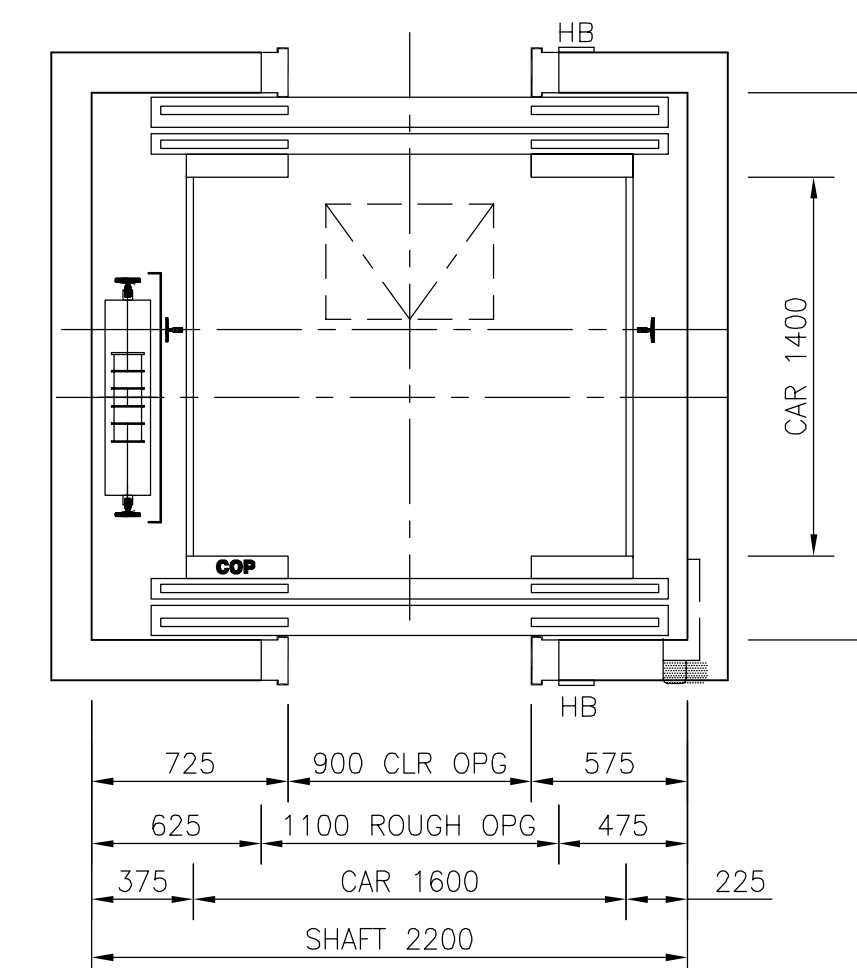
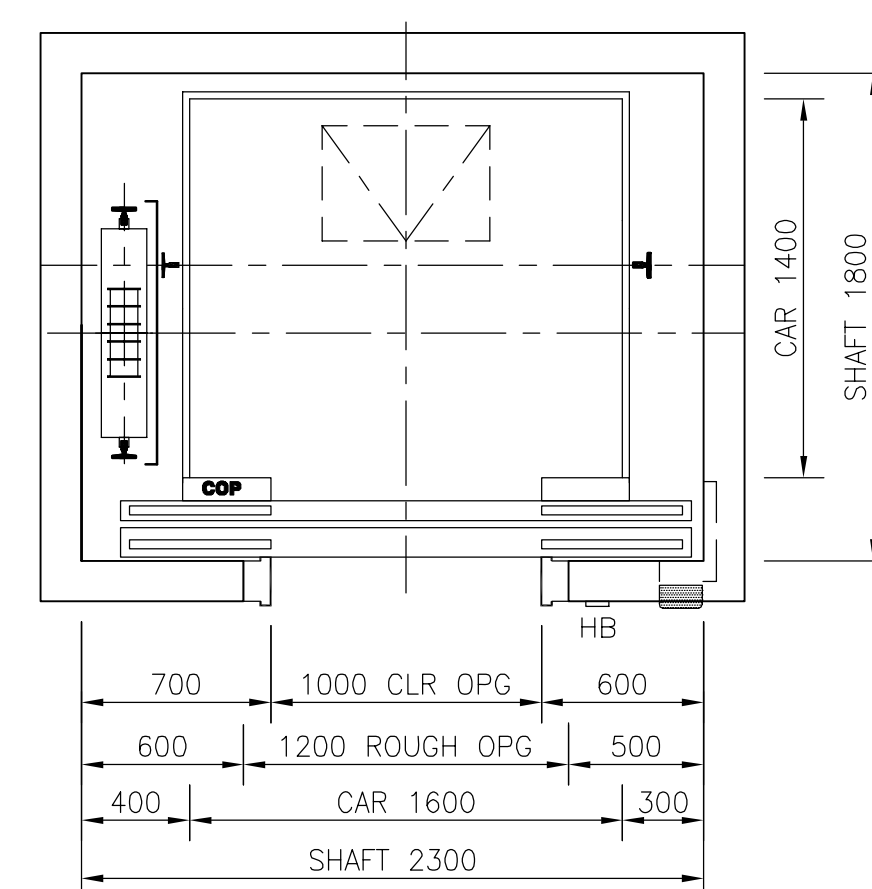
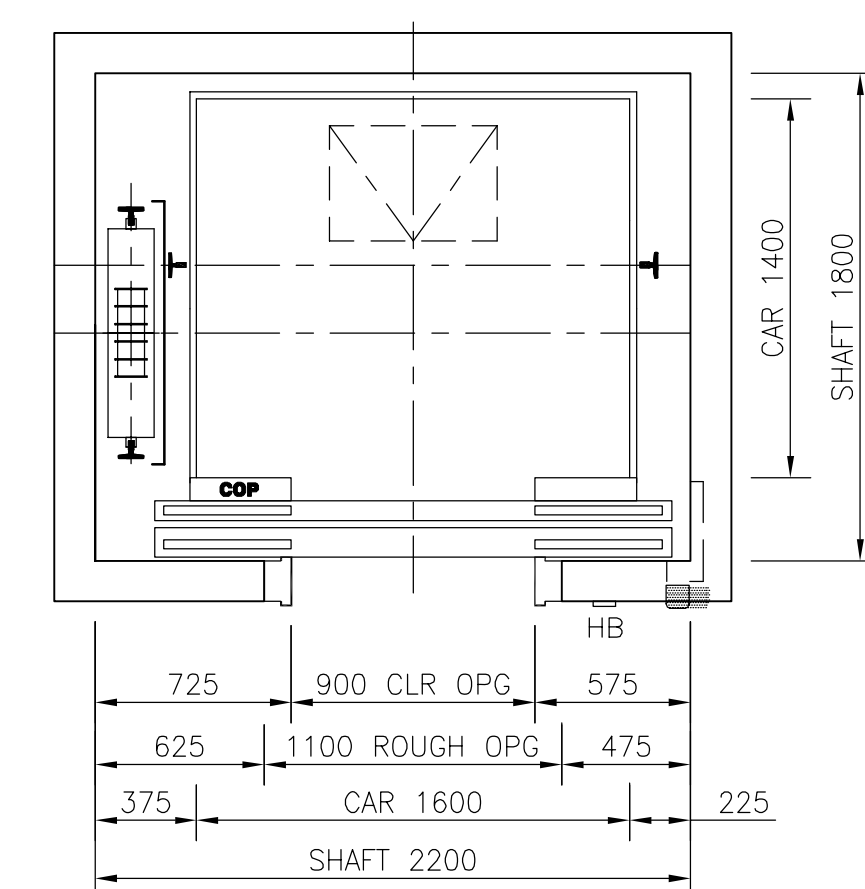

13 PERSON 1000kg WIDE CAR

STRETCHER CAPACITY

STRETCHER CAPACITY

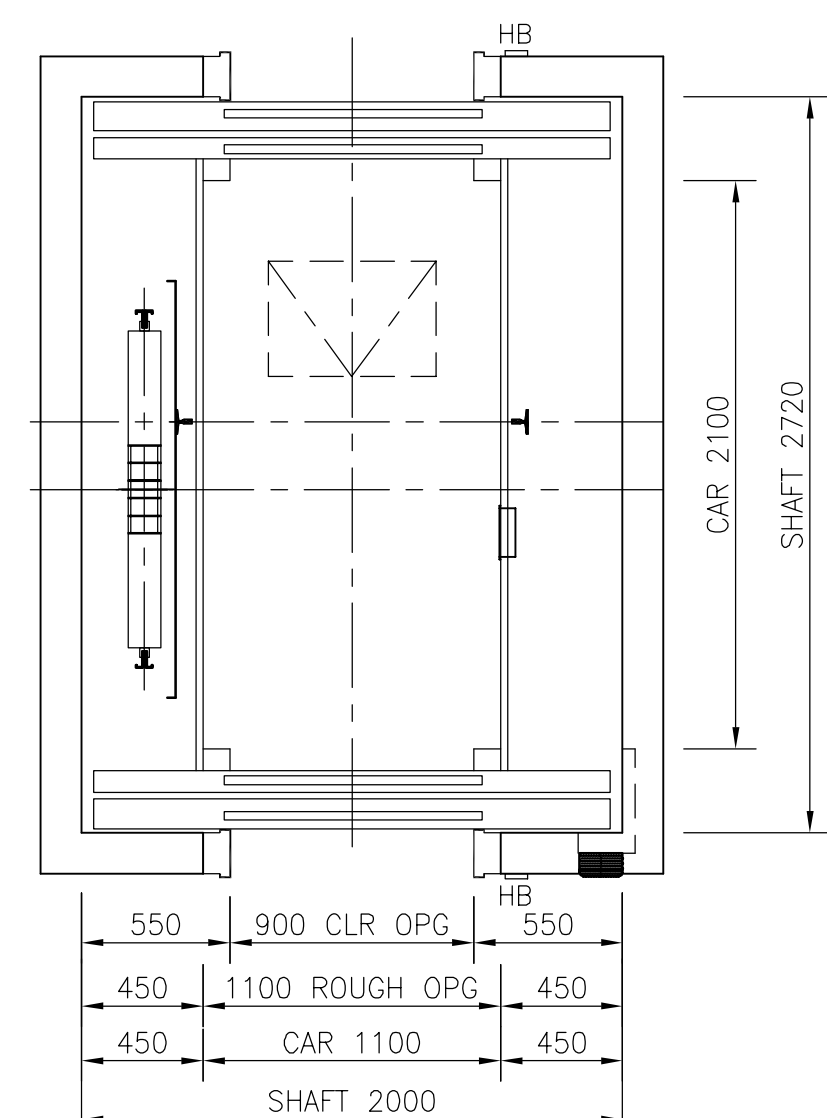
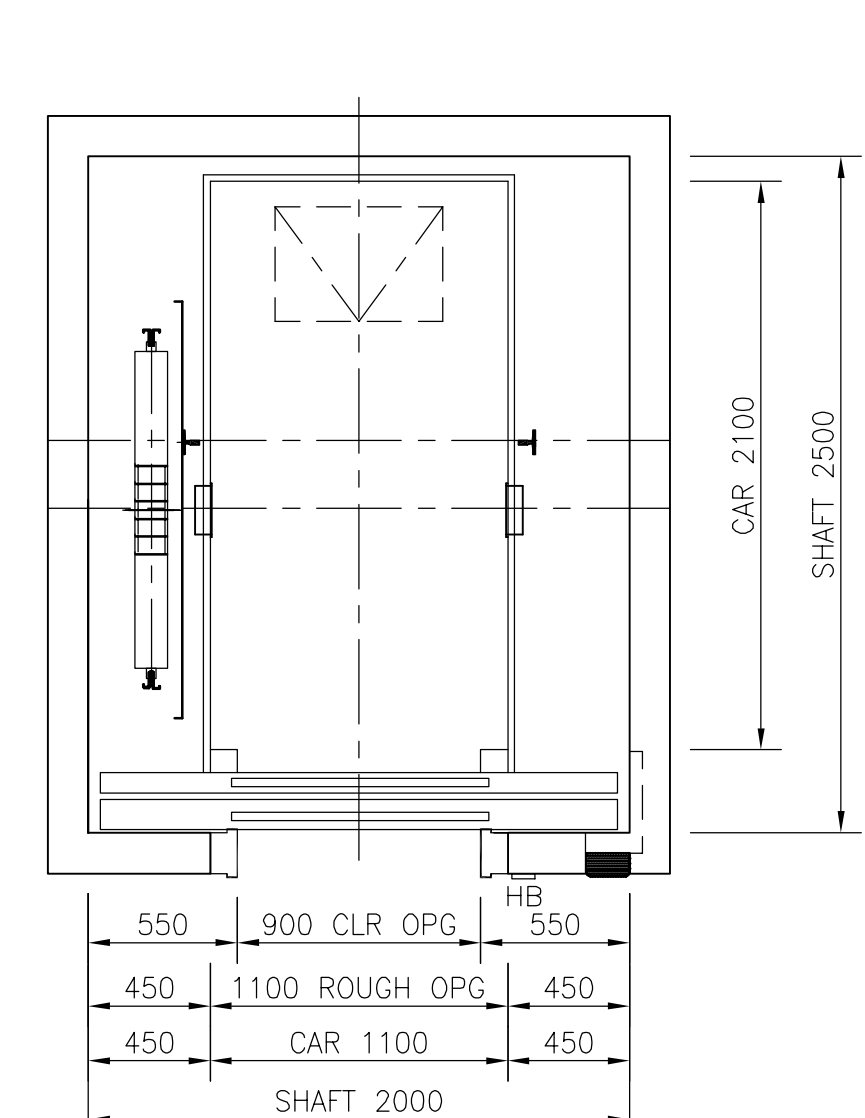

STRETCHER CAPACITY
13 PERSON 1000kg DEEP CAR

Catalogue Layout

This design tool illustrates hoistway dimensions for the **Gen2™** elevator system

This is design information only – not to be used for construction purposes

Please contact Otis for full **Gen2™** layout information

Otis Elevator Company Pty Ltd has offices throughout Australia and New Zealand

www.otis.com

Note:

These dimensions assume a concrete hoistway structure

All centre opening doors

Opposite machinery location available

Two and Three car arrangements available

FOR ITEMS TO BE PROVIDED BY PURCHASER REFER TO SHEET 2

Gen2™ Premier

MACHINEROOMLESS

WITHOUT COUNTERWEIGHT SAFETY

DRG.No.L-1-DESIGN INFORMATION

DATE: MAY' 2005 Dwg: SAA28158BN ALL RIGHTS RESERVED

OTIS

SHEET 1 OF 2