

GEN2 FLEX+ ELEVATOR

# The most adaptable elevator

---

**OTIS**





# Same space, greater capacity



## This elevator is ideal for any project, both new construction and refurbished buildings

- +** **UP TO 50% MORE CAPACITY**  
From 4 to 6 passengers without construction work.
- +** **MINIMUM HOISTWAY DIMENSIONS**  
Possible to install or to replace an elevator in tight spaces. It can also be installed in hoistways with low pits or overhead clearances.

Special configuration for elevators with two entrances at 90° and possibly panoramic elevators.
- +** **SAVINGS**  
Maximize energy efficiency by combining LED lighting, standby-mode and regenerative technology as standard.
- +** **AESTHETICS**  
Choose a design that compliments your project style with more than 400 000 custom combinations.



# More passengers in the same space

**FROM 4 PASSENGERS**  
CONVENTIONAL ELEVATOR

**TO 6 PASSENGERS**  
GEN2 FLEX+ ELEVATOR

**MACHINE ROOM**

- 1 Controller
- 2 Machine
- 3 Overspeed governor

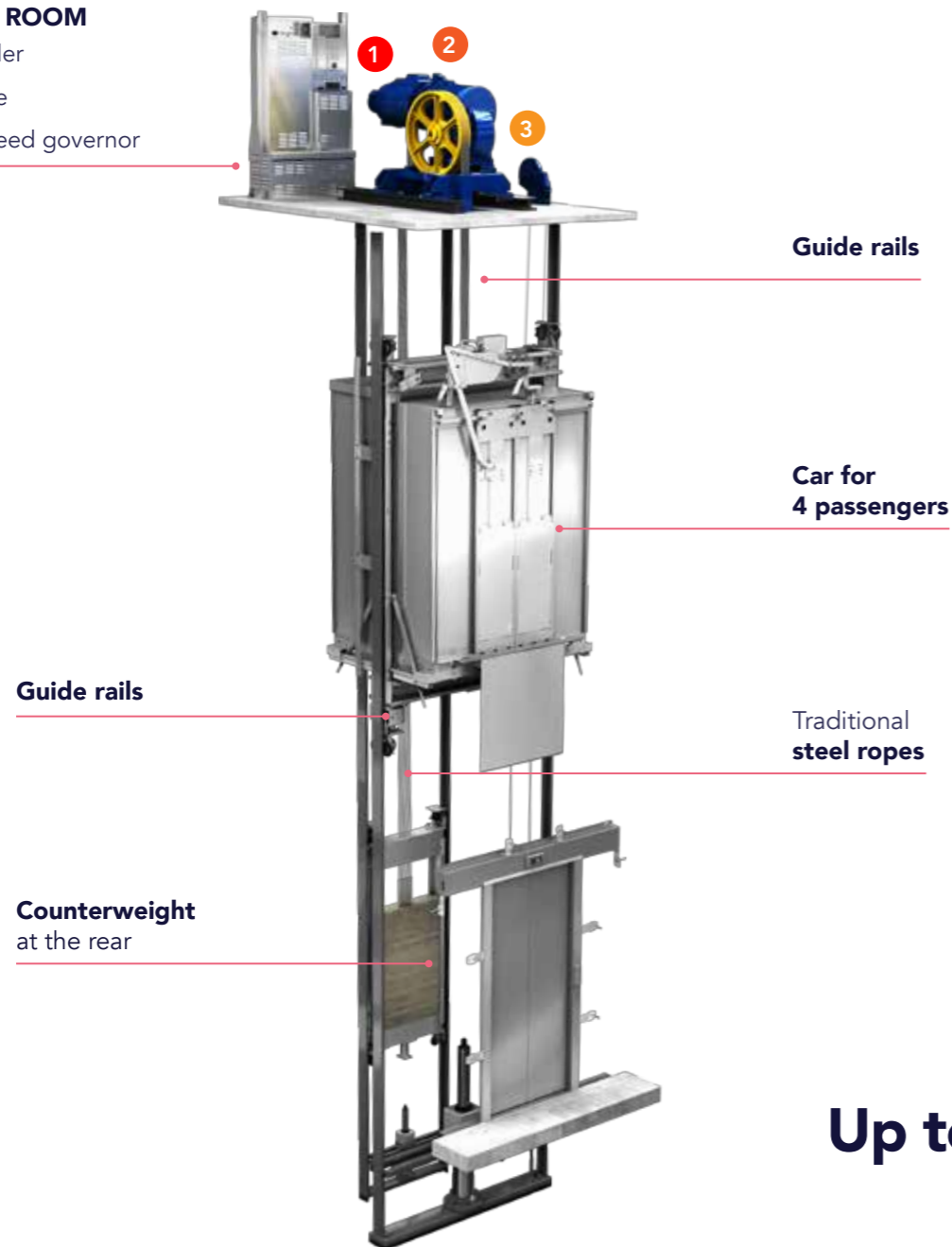

Machine room eliminated

Machine installed in the hoistway

Overspeed governor

Guide rails at the side

Counterweight at the side

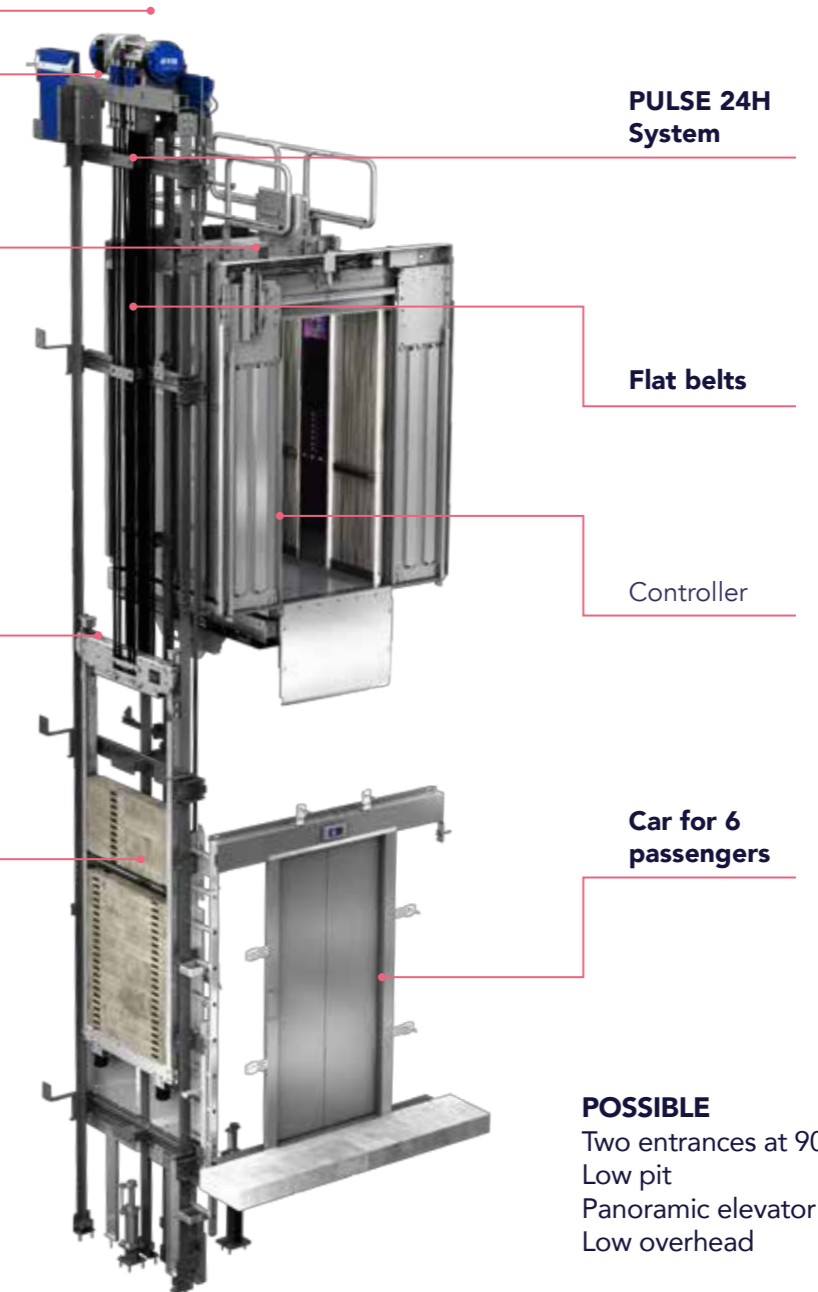

**Up to 50% more capacity**

# Enjoy the technological advantages

- + COMFORT**

The machine is 80% smaller than a conventional one, and thus allows it to be installed in the hoistway. You can use the machine room for another use as a cleaning room, lumber room etc.

The traditional ropes are replaced by flexible flat steel belts which provide a very smooth car operation and its variable frequency system guarantees starts and stops that are hardly noticeable.
- + RELIABILITY AND SAFETY**

Thanks to the Pulse System, the flat belts are continuously monitored 24 hours a day, 7 days a week and last 3 times longer than traditional ropes.

The Gen2 Flex+ achieves outstanding stopping accuracy, making it easy to enter and exit the car and avoiding trips or falls.
- + ENERGY SAVINGS**

The machine is up to 50% more efficient than a conventional geared machine.

The Gen2 Flex+ is equipped with a regenerative system, the ReGen Drive. In conventional elevator systems, the energy generated by the elevator is dissipated in the form of the heat. The ReGen Drive is able to capture this energy and feed it back into the building grid, where it can be used to power other electrical components.

Led lighting, up to 80% savings when combined with standby features.
- + SUSTAINABILITY**

The flat belts and the machine are lubrication-free, thus contributing to environmental protection.
- + ENHANCED BUILDING**

Installing a Gen2 Flex+ elevator increases a building's value, makes the property more accessible and residents' lives easier.

**SILENT**  
**COMFORTABLE**  
**LOW CONSUMPTION**



# Gen2 Flex+ specifications

The Otis Gen2 Flex+ was engineered to fit into any type of hoistway and can be configured with the guide rails and the counterweight to one side or with the guide rails to both sides and the counterweight behind the car.

## TRACTION EQUIPMENT

- Gearless sealed machine and permanent-magnet motor
- Traction by means of flat belts
- 2:1 configuration with cantilever type suspension

## CONTROL

- Closed loop, variable frequency

## CONTROLLER

- Modular microprocessor control system, combined with an advanced variable frequency, variable voltage drive
- Located in the landing door column on the top floor. As an option, it can be installed at a distance of up to 20 metres
- Two-way communication and remote intervention system

## OPERATION

- Simple automatic. Down collective. Selective collective
- Up to 3 elevators in a group

## TYPES OF DOORS

- Automatic telescopic doors, centre-opening or semi-automatic BUS doors
- Equipped with a variable speed, digital control system, self-cleaning slotted sill and aluminium door track with protected roller system
- Stainless steel finish or prime coated steel ready for finishing

## ENTRANCES

- One or two entrances (90° and 180°)

Door height	Car height	Overhead clearance at 1.0m/s	Minimum pit Granite flooring	Minimum pit Rubber flooring	Dimensions of controller cabinet 2100mm high x 330mm wide x 95mm deep
2000	2100	3300	400	380	
2000	2200	3400	400	380	
2100	2300	3500	400	380	

Possibility of combining minimum overhead and minimum pit (consult measurements)  
Minimum pit 400/380 mm models with 1 entrance; consult Otis for other models and for lower overhead clearances as well.

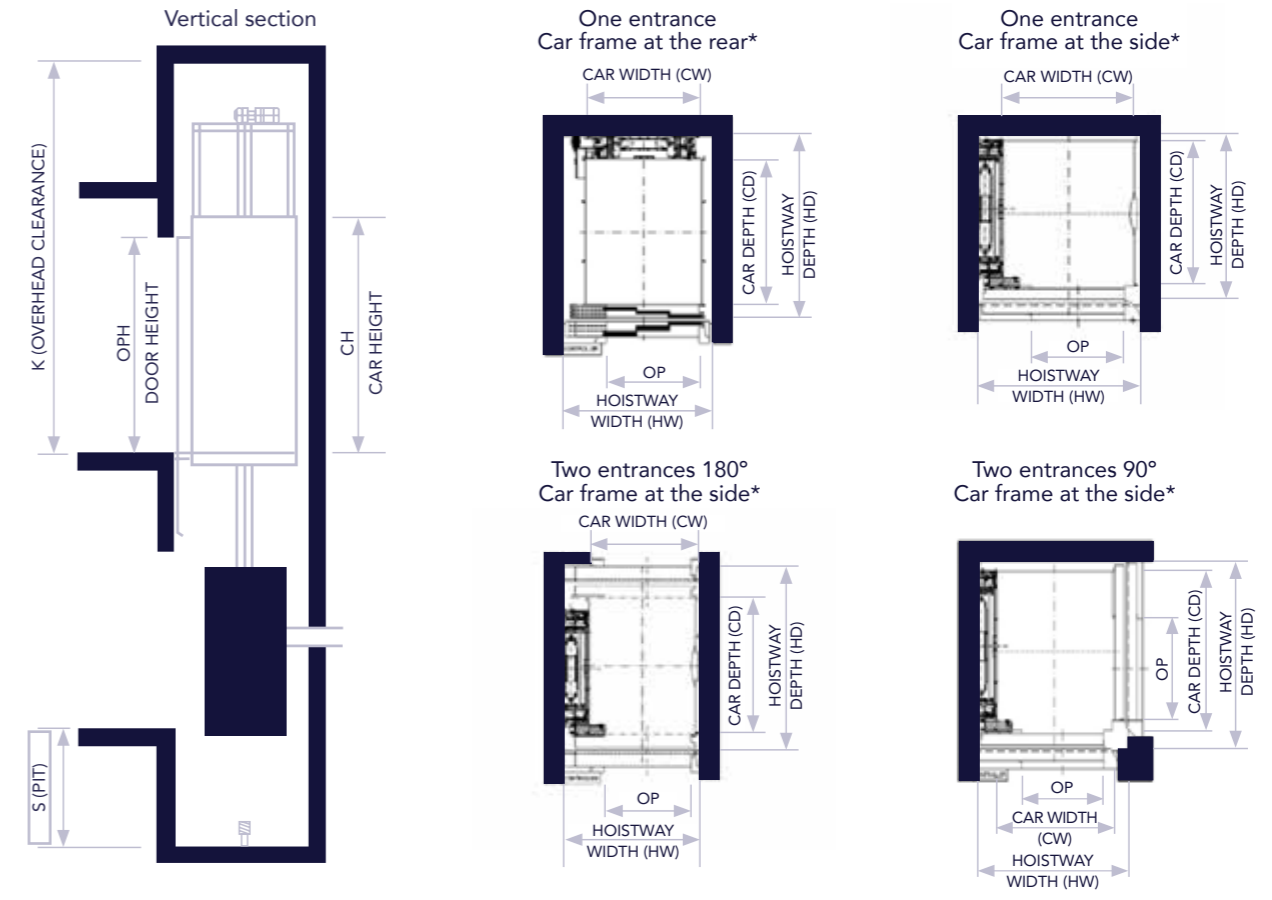

\*Consult Otis about type of doors.

Duty Load (Kg)	225 to 630	
Passenger capacity*	3 to 8 passengers	
Speed (in m/s)	1	
Car dimensions (mm) Counterweight on side-wall	Width	750:1250
	Depth	790:1500
Car dimensions (mm) Counterweight on rear-wall	Width	790:1500
	Depth	750:1250
Maximum number of stops	16	
Maximum rise (m)	45	
Cars in groups	Up to 3	
Car entrances	1 or 2	
Counterweight safeties	Optional	
Standard Power	380 - 400 - 415	
Frequency (Hz)	50 - 60	
Stopping accuracy (mm)	±3	

\* Consult Otis about other passenger capacity.



# Natural and Modern Collections

New car designs that combine distinct forms, materials, textures and lighting. Two different collections: Natural and Modern, each of which has three finishes Standard, Advanced and Premium.

The car interior uses indirect LED lighting integrated into the four corners, creating a sensation of space and depth, and stressing the textures of the materials used.

## eView

The constant work carried out by OTIS in research and design to create products that bring safety and comfort to elevators has made eView a reality.

eView is an innovative audiovisual intercom specifically designed for elevators, a unique product on the market.

This device provides two-way communication with Otis' 24-hour Service Centre by videoconference, offering passengers a greater feeling of comfort and security.

In addition, it acts as a broadcaster of general contents, news, weather forecasts, cultural information, etc.



— Otis Elevator Company is the world's leading manufacturer and maintainer of elevators, escalators and moving walkways.

Founded more than 165 years ago by the inventor of the safety elevator, Otis offers products and services through its companies in more than 200 countries and territories, and maintains approximately 2 million elevators and escalators worldwide. Every day, Otis moves more than 2 billion people through the world's urban landscapes.

Otis is a unit of United Technologies Corporation (UTC), a leader in the global building systems and aerospace industries.

For more information, visit [www.otis.com](http://www.otis.com) or follow Otis on LinkedIn, YouTube and as @OtisElevatorCo on Twitter, Facebook and Instagram.