

OTIS GENESIS

Start your experience off right

OTIS



Modern living starts here

The Otis Genesis has been designed for residential buildings and other segments, taking into account all needs for cost efficient living.

- + MAXIMIZE COMFORT AND SILENT OPERATIONS**
With Otis Gen2® proven technology
- + MAXIMIZE ENERGY EFFICIENCY**
By combining LED lighting, standby-mode and regenerative technology as standard
- + ENHANCE BUILDING DESIGN**
With a wide range of panels and colors, landing doors, control panel and hall fixture options

Genesis offers the essentials of modern elevator technology while optimizing your budget.



Our innovative thinking comes standard in each component for best-in-class results.

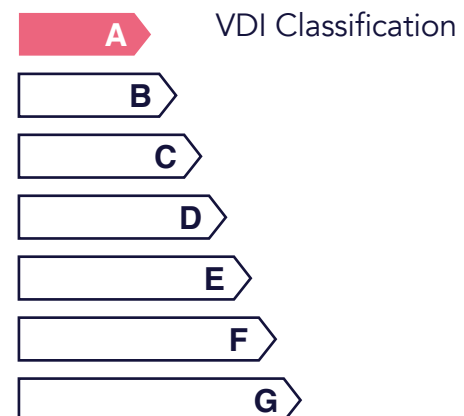

320 / 400 / 450 / 525 / 630 / 1000 KG

45 M / 16 STOPS

4 / 5 / 6 / 7 / 8 / 13 PASSENGERS

1 M/S

MAIN TECHNICAL SPECIFICATIONS

Machine roomless	Yes
Motor type	Gearless with permanent magnets
Energy regeneration	Regen drive comes standard
Traction system	Polyurethane-coated, stainless-steel flat belts
Energy savings / standby mode	Standard
LED lighting	Standard
Remote elevator monitoring	Optional

Leading-edge technology comes standard



COMFORT AND SILENCE

Flexible belts make our machine up to 80% smaller and up to 50% more efficient than conventional geared machines.



PERFORMANCE

Our patented coated steel belts allow a smooth and quiet ride like never before. No metal-on-metal contacts reduce building vibration and unwanted noises.



SAFETY AND RELIABILITY

Pulse from Otis provides constant analysis of the belts to identify wear and repair needs proactively, meaning less inspection downtime and more safety and efficiency.



MONITORING

REM™ (Remote Elevator Monitoring) accumulates real-time information to accurately identify and correct most problems quickly. This optional, internet-based system takes the guesswork out of repairs and dramatically reduces service interruptions.

01. MACHINE ROOMLESS

All equipment in the hoistway, controller at landing

02. GEARLESS MACHINE

50% smaller / more efficient

03. BELTS

20% lighter than ropes, lubricant free and up to 3 times longer lifetime

04. PULSE

24/7 belts monitoring

05. REGEN DRIVE

Up to 75% more efficient than non-regenerative drives

06. LED LIGHTING

Up to 75% savings when combined with standby features

07. STANDBY MODE

Up to 50% savings on Gen2 elevator standby power

08. RIDE QUALITY

53 [dB(A)] In-car noise and
12 [milli-g] Vibrations x/y/z

09. STOPPING ACCURACY

+/- 3 mm

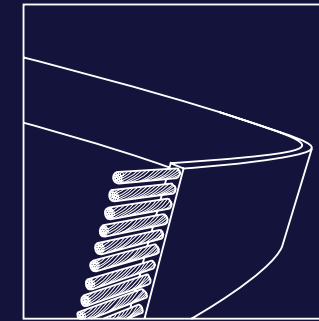

Patented Otis Gen2 belts replace conventional ropes

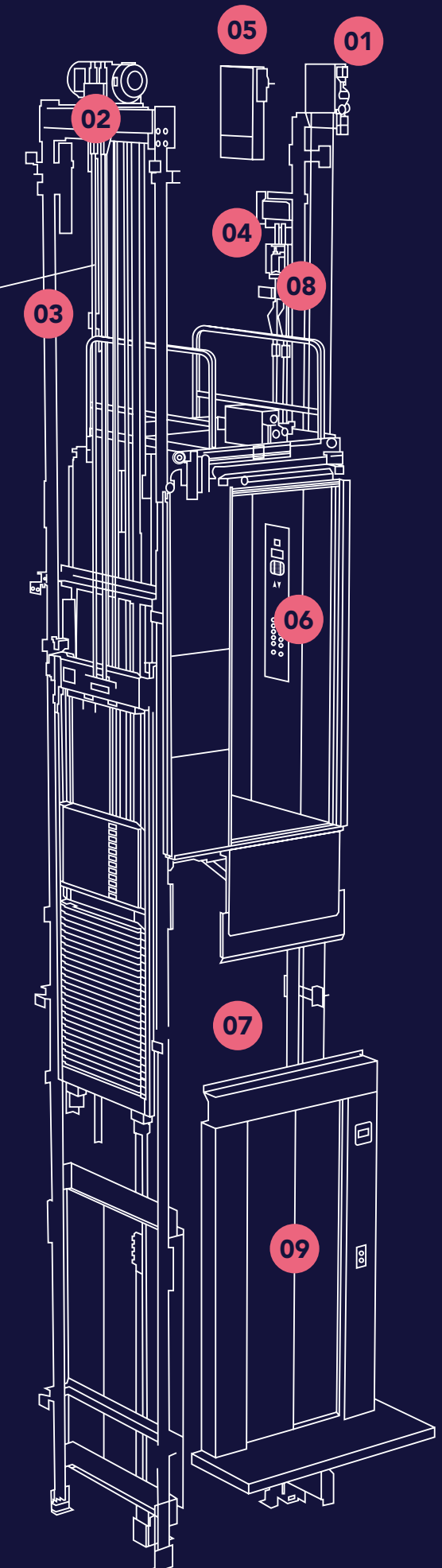

Refined living

SKINPLATE COLLECTION



Royal mahogany Dark grey Linen silk Natural silver Structured Silver Marble

DARK GREY AMBIANCE



Kickplate PVC

ROYAL MAHOGANY AMBIANCE



Kickplate PVC

RUBBER FLOORS



Black stone



Natural cement



MARBLE AMBIANCE

OPTIONAL FLOOR
Cars are available with or without a floor

Refined living

STAINLESS STEEL COLLECTION

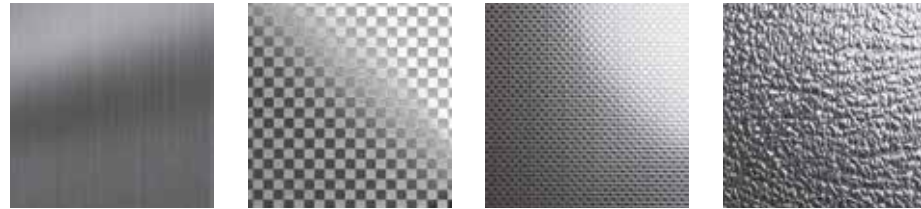

Brushed aluminum Dama Linen Buffalo skin

BUFFALO SKIN AMBIANCE



Kickplate aluminium

LINEN AMBIANCE



Kickplate PVC

RUBBER FLOORS



Black stone



Natural cement



BRUSHED STAINLESS STEEL AMBIANCE

OPTIONAL FLOOR
Cars are available with or without a floor

Refined living



**CONTROL PANEL OPPOSITE
HANDRAIL POSITION**



**CONTROL PANEL SIDE
HANDRAIL POSITION**



REAR HANDRAIL POSITION

CEILING

White skinplate with LED lights



Stainless Steel with LED lights



* IF CW (CAR WIDTH) \geq 1050, THE CEILING WILL HAVE 4 SPOTS

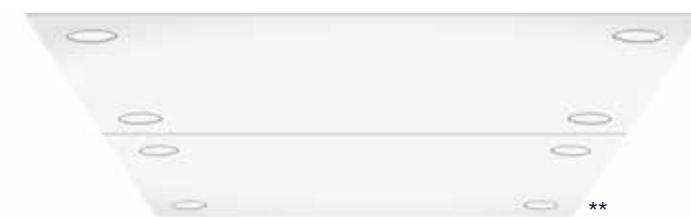

** CEILING WITH 8 SPOTS FOR CAR OF 1000 KG

HANDRAILS



Rounded Bar and Support finish, mirror chrome



Rounded Bar and Support finish, brushed chrome

MIRRORS

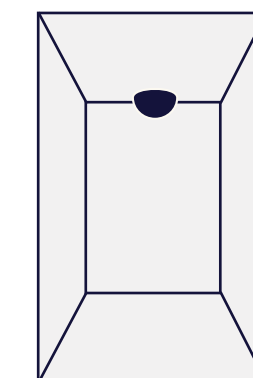

Rear-view mirror

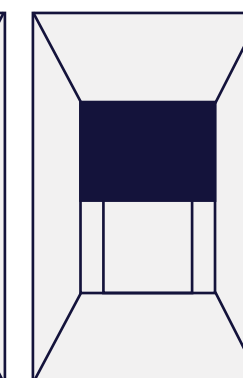

Full width

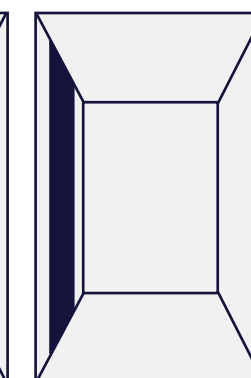

Full length central mirror.
Only available for
2 entrances 180°

KICKPLATES

- PVC
- Aluminium brushed chrome or mirror chrome (only for "Full length central mirror"), same finish as the handrail

Refined living

STANDARD HALL BUTTON



LANDING DOORS

Telescopic doors with 2 panels

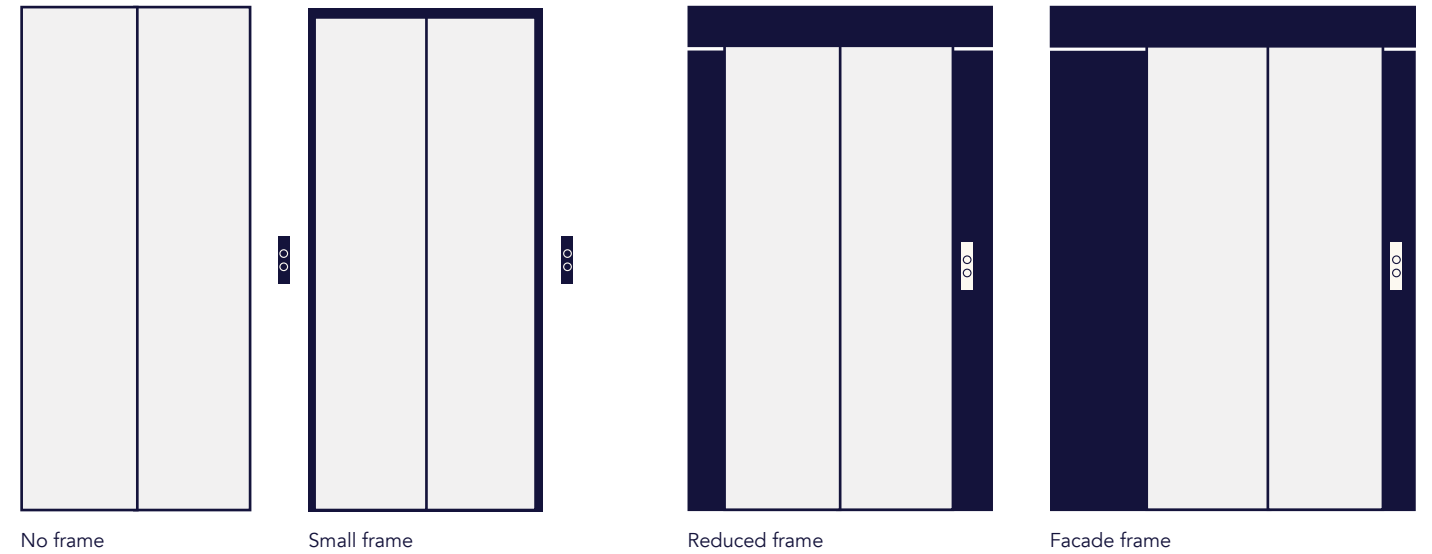

HALL FIXTURES



Genesis specifications

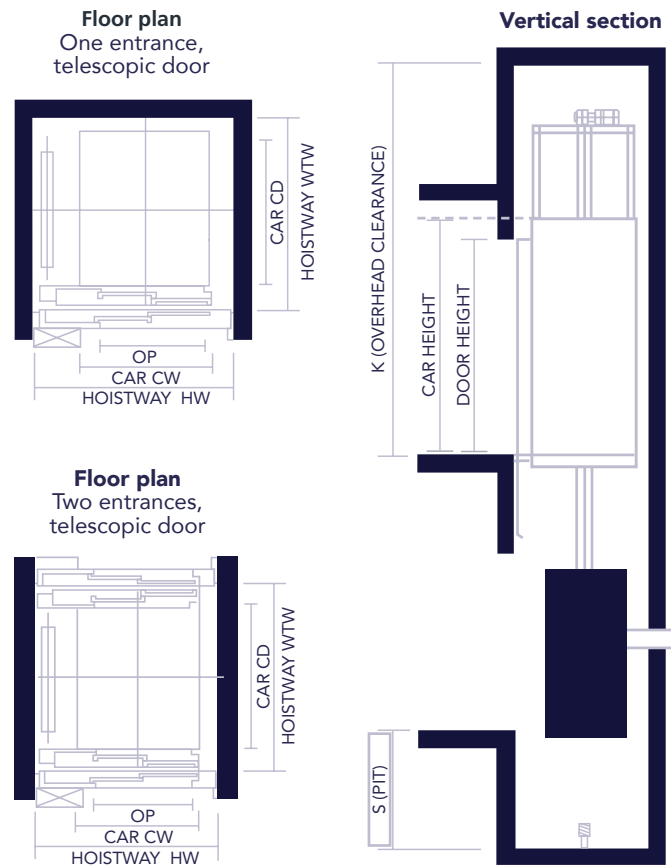

Duty load (kgs)	320	400	450	480	525	630	1000	
Passenger capacity	4	5	6	6	7	8	13	
Speed (in m/s)	1							
Car dimension (mm)	Width (CW)	840		1000		1100		
	Depth (CD)	1050	1200	1250	1300	1350	2100	
	Height (CH)	2100 or 2200						
Door dimension (mm)	Opening height (OPH)		2000 or 2100					
	Opening width (OP)	Telescopic (TLD)	700	700	800 900	800 900	800 900	900
Hoistway dimension (mm)	Width (HW)		1350	1350	1550 1650	1550 1650	1600 1650	1650
	Depth (WTW)	1 entrance	1300	1450	1500	1550	1600	2350
		2 entrances	1400	1550	1600	1650	1700	2450
Standard overhead (K) mm	3400*							
Standard pit (S) mm	1000							
Top of car balustrade (mm)	900 or 1100 depending on configurations - possible impact on K dimension							
Maximum number of stops	16							
Maximum rise (m)	45							
Cars in group	up to 2							
Car entrances	1 or 2							

*The overhead could increase 200 mm depending on the hoistway dimensions. Consult OTIS for other dimensions of pit and overhead.

A TRUSTED GLOBAL PARTNER

+ SALES SERVICES
For every project, you have a dedicated sales representative taking care of your project. Our team will be here to answer your questions from the start of your project until final hand-off.

+ FIELD SERVICES
Every project is unique. That's why you'll have a single field contact at Otis throughout the entirety of your project. They will help with coordination to make your project faster and more efficient.

A COMMITMENT TO EXCEPTIONAL SERVICE

+ OTIS SERVICE
Otisline®, 24/7 service to accelerate response time to reduced dramatically elevator downtime.

+ eSERVICE CUSTOMER PORTAL
The eService customer portal provides 24/7 remote access to Genesis systems, simplifying elevator management and monitoring. It allows users to view performance data, place service calls. The simple interface is compatible with computers, tablets and mobile operating systems.



— Otis Elevator Company is the world's leading manufacturer and maintainer of elevators, escalators and moving walkways.

Founded more than 165 years ago by the inventor of the safety elevator, Otis offers products and services through its companies in more than 200 countries and territories, and maintains approximately 2 million elevators and escalators worldwide. Every day, Otis moves more than 2 billion people through the world's urban landscapes.

For more information, visit www.otis.com or follow Otis on LinkedIn, YouTube and as @OtisElevatorCo on Twitter, Facebook and Instagram.